

H cm	B1 cm	B2 cm	pendenza	luci ml
120	20	28	15%	8 - 12
150	32	32	12%	10 - 15
	20	28	15%	12 - 16
200	32	32	12%	15 - 20
	20	28	15%	16 - 20
240	20	28	15%	20 - 24
255	28	28	12%	24 - 30
280	50	50	8%	30 - 40
281	32	32	12%	24 - 30
320	50	50	8%	40 - 50

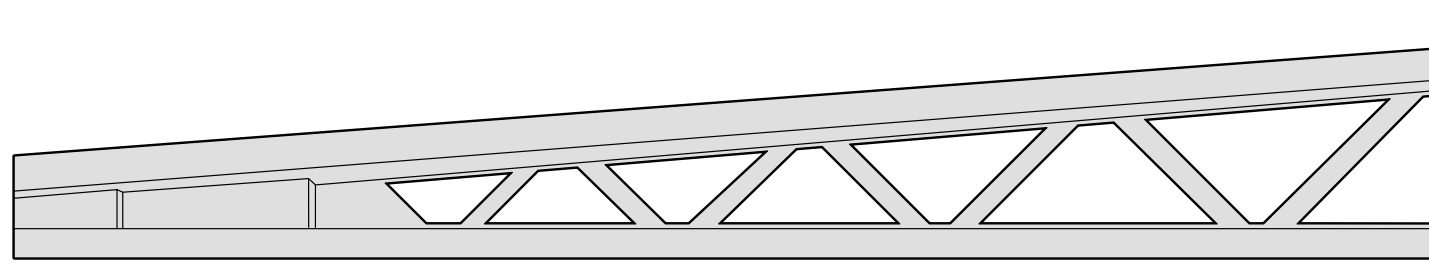

## Schede Tecniche

SCHEDA D.P. 2.6  
rev. 0602

### Doppia pendenza

Tipologia travi  
reticolari